



ISO 9001
BUREAU VERITAS
Certification



ÉOLINE
Welded static hood
H=500mm



VENTILATION OF PROFESSIONAL KITCHENS, A SPECIALIST AFFAIR.

DESIGN / MANUFACTURE

EOLINE hoods are available in 1000, 1500, 2000 and 2500mm lengths. They have no visible fixings on the outer faces and in the extraction volume.

Crimped ØM8 nuts are built into each end of the extractor, making it possible to suspend them from threaded rods.

The production method used, with folds on all visible parts, gives a finish that is free of burrs and protruding parts.

The front face / sides are welded together and polished over the full height.

The extractor lower corners are welded, providing perfect leak tightness.

All visible parts are manufactured from AISI 304 austenitic stainless steel (CN 18-10), brushed finish 220 grade on both sides with PVC protection.

AS AN OPTION The entire hood (visible parts, excluding filters) can be matched to the kitchen appliances using MATT, SATIN or GLOSS paint.

A choice of colours is available:

- Black: RAL 9005
 - Blue: RAL 5000
 - Bordeaux: RAL 3000.
- (Other colours on request).

Baffle filters 398x498x25mm with stainless steel frame and handle (flow of 600m³/h per filter). As an option, **HE filters** (flow of 500m³/h).

lighting from embedded spots.

The lateral casing (sides) are assembled using heat-welded pins and nuts.

In the lower part, the extractor is fitted with a G3/8 stainless steel purge cap to drain off grease and condensates.

DIMENSIONS / WEIGHT

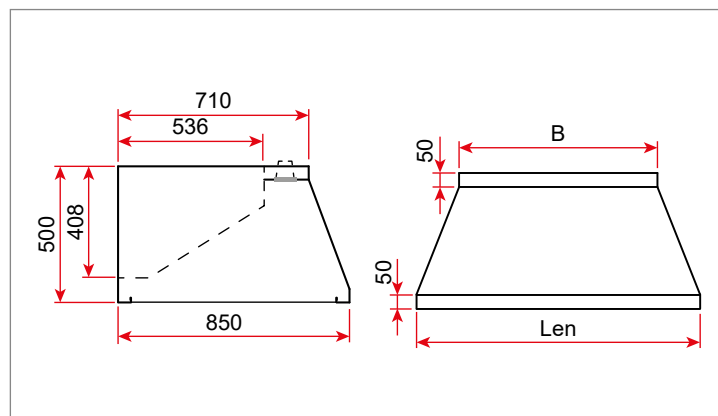

Len (mm)	1000	1500	2000	2500
B (mm)	720	1220	1720	2220
Weight (kg)	35	53	70	87
No of spots	2	2	3	3

CONNECTIONS: Diameter and recommended number of hoops

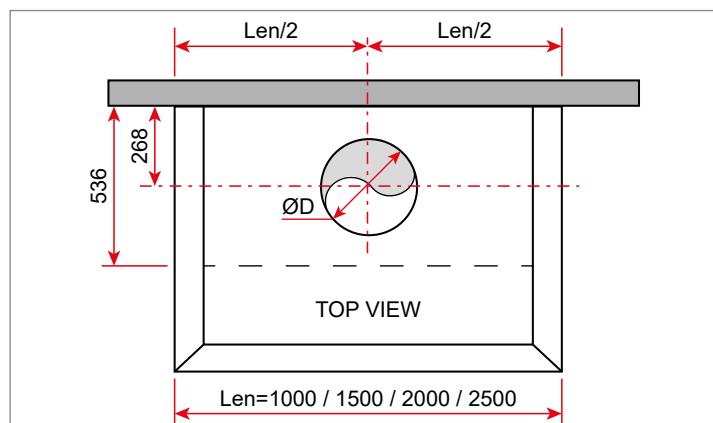

Len (mm)	1000	1500	2000	2500
ØD (mm)	315	315	355	400

Drilling and connection hoops as an option